



# **2K Front Recording Single-Channel Dash Cam**

## **User Manual**

The information in this manual is subject to change without notice.  
[www.rexingusa.com](http://www.rexingusa.com)

Activate Your

# 18-Month Warranty

& Unlock Exclusive Perks!

Activate within 30 days of purchase to  
**extend your limited 12-month warranty to 18 months**  
and unlock bonus rewards just for registered users.

Scan the QR to register &  
discover your exclusive perks.

SCAN  
ME!



<https://www.rexingusa.com/productreg/>

# 1. Overview

## Thank you for choosing **Rexing!**

We hope you love your new products as much as we do. If you need any assistance, or have any suggestions to help us improve, please contact us.

 **care@rexingusa.com**

 **(877) 740-8004**

Our support team will respond to you as soon as possible.  
Always a surprise in Rexing.

## Check us out here

- <https://www.facebook.com/rexingusa/>
- <https://www.instagram.com/rexingdashcam/>
- <https://www.rexingusa.com/support/registration/>
- <https://www.rexingusa.com/support/product-support/>

 **Facebook**



 **Instagram**



 **Site**



 **Product Support**



## 2. What's in the Box

1.



2.

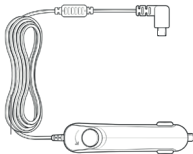

3.



4.



5.



6.



7.



8.



1. Rexing C1 Dash cam
2. Car Charger
3. Warning Sticker
4. Cable Management Tool
5. Cable Clips
6. Quick Start Guide
7. Safety Guide
8. Electrostatic Sticker

### 3. Camera Overview

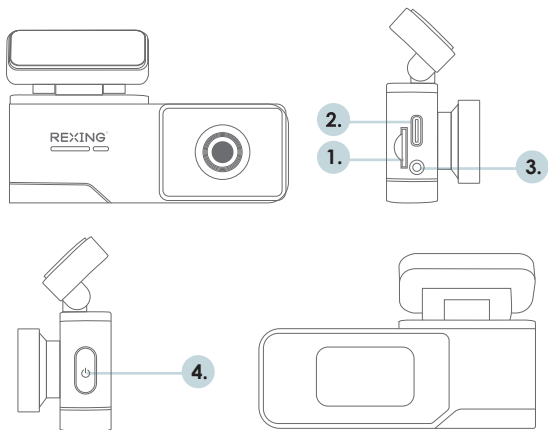

1. Micro SD Card Slot
2. USB Type C Power Port
3. Rear Camera Port
4. **Press:** Take a photo  
**Hold for 5 seconds:** Cycle through Recording, Screensaver, and Wi-Fi models.  
**Hold for 10 seconds:** Restore factory settings and reboot the device.

#### **Note:**

- The memory card will be automatically formatted when inserted. Please back up your data beforehand.
- To format the card manually, please use the mobile app.
- The power button does not format the memory card.

## Screen Icons

Flashing Red: Recording in progress

Flashing Yellow: Current video slip is locked

Gray: Wi-Fi Standby

Green: App Connected

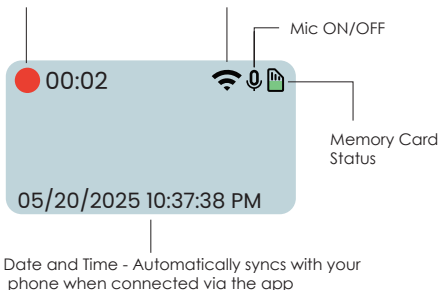

## 4. Installation

### Step 1: Installing the Electrostatic Stickers

#### 1.1 Prepare Your Windshield

Thoroughly cleanse your windshield with either water or alcohol. Follow this by wiping it dry using a clean, dry cloth to ensure a spotless surface.

#### 1.2 Position the Sticker

Next, carefully peel off the protective film from the electrostatic sticker. Attach the sticker to the windshield, ideally behind the rear-view mirror. This position is recommended to avoid obstructing your view while you're on the road.

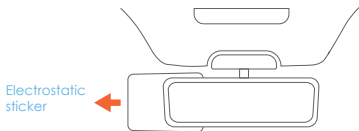

### Step 2: Install the Dash Cam

Peel off the protective film from the 3M adhesive on the dash cam mount. Carefully position the dash cam on the windshield, ideally behind the rear-view mirror, then press firmly to attach it.

**Important!** The adhesive mount is permanently fixed to the dash cam and cannot be separated. Please ensure the dash cam is aligned correctly before installation. Once installed, do not attempt to remove and reposition, as this may reduce adhesive strength.

### Step 3: Insert the Memory Card

The Rexing C1 accepts [Class 10/ UHS-1 or higher] Micro SD memory cards up to 128GB. You will need to insert a memory card **before you can begin recording. Before inserting or removing a memory card, first ensure you've powered down the device.**

Gently push the memory card in until you hear a click, and allow the spring release to push the card out.

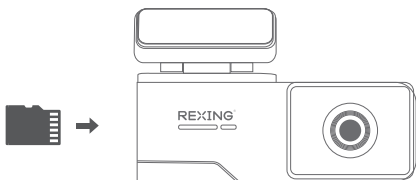

## Step 4: Power the Camera and Format the Memory Card

**Power the camera** by connecting the charger to the car cigarette lighter and the camera.

To ensure proper recording, a newly inserted memory card will be **automatically formatted** by the camera. Please make sure to back up any important data before inserting the card.

**⚠** The formatting process starts automatically—**no prompt will appear on the screen**, and the POWER button cannot be used to format the card.

If you need to manually format the memory card later, please use the **Rexing Connect App**.

Once formatting is complete, the device will automatically start recording.

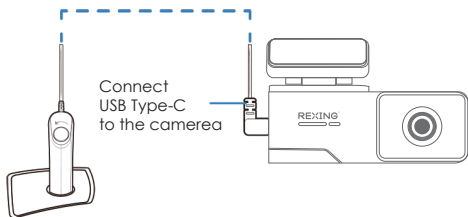

**You may now disconnect from power. The camera will shut down after 3 seconds. The camera should begin recording automatically the next time it is powered on.**

## Step 5: Installing the Camera onto the Windshield

Place the camera on the mount and carefully route the power cable around the windscreen and tuck in under the trim.

Plug the Car Charger Cable into a 12V DC power outlet or the car cigarette lighter.

Connect car charger to the camera. The camera will auto-start recording once powered on.

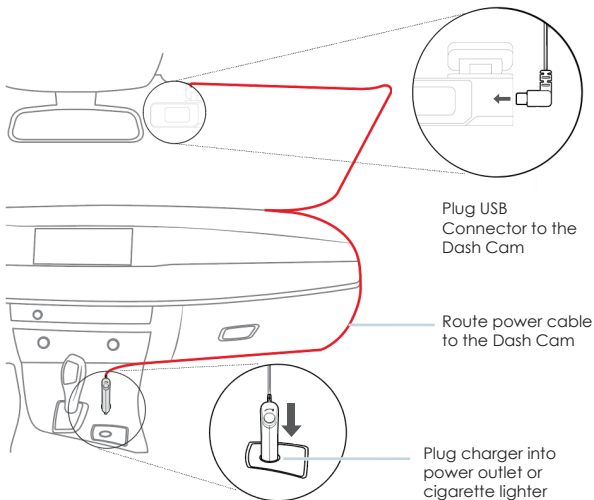

## 5. Basic Operation

### Device Power

The device is automatically powered on when plugged into a 12V accessory socket or cigarette lighter and receives a charge (i.e.: the vehicle is started.)

To turn the device on manually, press and hold the **POWER** button until the welcome screen appears.

The camera will automatically start recording when powered on.

Press and hold the POWER button to turn the device on manually



## Rexing Connect App

Easily download the app by scanning the QR code below or search via the App Store or Google Play



## Wi-Fi Connect Troubleshooting

If you bring up the Rexing Connect app and cannot connect your phone to the dash cam please go to <https://www.rexingusa.com/wifi-connect/> OR scan the QR code below.



# Wi-Fi Connect

## Step 1

With the dash cam powered on, the Wi-Fi function will automatically enter standby mode.

If it does not appear, hold the Power button for 5 seconds to cycle through Recording, Screensaver, and Wi-Fi modes.

## Step 2

On your mobile device, navigate to your Wi-Fi settings. Connect to your dash cam's Wi-Fi by tapping its name (HX\_XXXXXX) when it appears. Enter your dash cam's Wi-Fi password (default: 12345678) if you are prompted to do so.

**Note:** On some mobile devices, you may have to try to connect more than once. To ensure you've successfully connected, your mobile device's screen should resemble the examples shown.

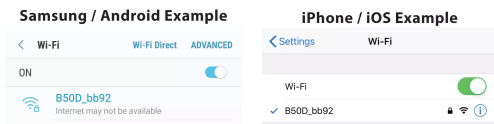

### Step 3

Once you're connected to the dash cam, open the Rexing Connect app on your mobile device.

Please select "Keep Trying Wi-Fi" if you see the notification on the right.

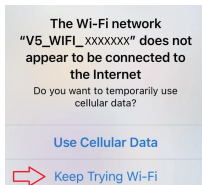

### Step 4

In the app, hit the "Connect" button to connect to your dash cam, allowing you to access live view and view/download your recordings.

**Note:** Turn OFF your phone Wi-Fi to disconnect.

# Menu Settings

## APP Main Screen

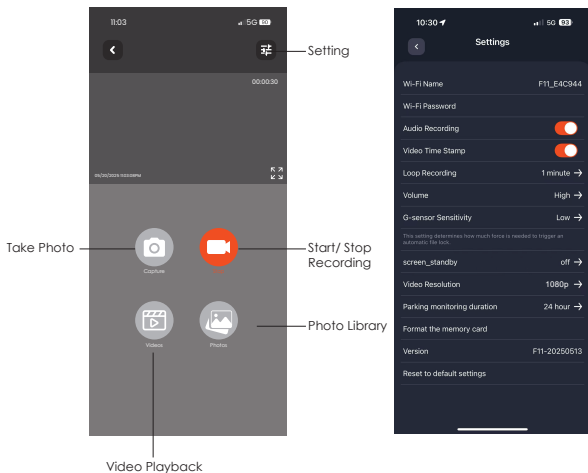

## Time and Date

Updates automatically to match your phone when the app is connected.

## Video Playback

The video playback can be accessed from the app home screen.

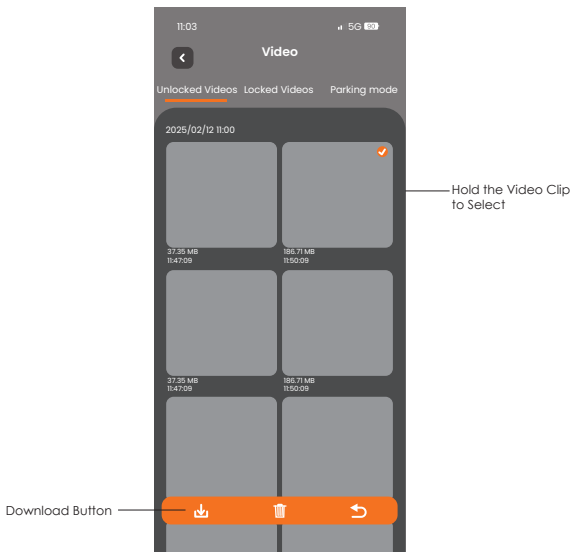

## Parking Monitor (Parking Surveillance Mode)

Parking monitor provides surveillance on your parked vehicle. When the engine is off, the hardwire kit is used to provide continuous power and protect your car battery from being discharged.

### Option 1: Vibration Detection

**To enable the Parking Monitor, you'll need to connect it with an OBD Smart Hardwire Kit or a Smart Hardwire Kit (sold separately).**

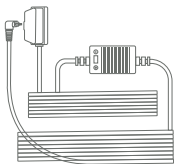

This feature will allow the dash cam to switch to parking mode automatically if the vehicle's engine turns off and switch back to the normal recording after the vehicle's engine turns on.

### Gravity Sensing Record:

The Gravity Sensing detects significant or sudden movement (such as an impact or collision), it will trigger an event recording.

**Please DO NOT ENABLE the Parking Monitor function in the settings of the Rexing Connect App WITHOUT connecting a smart hardwire kit. Otherwise it may case a malfunction.**

## Option 2: Motion Detection

To use this feature, you need to connect it with a Rexing 360° Intelligent Hardwire Kit (sold separately).

**Make sure that the Parking Mode is turned off on your Rexing Connect App, otherwise it may cause a malfunction.**

Once the sensor has detected MOTIONS. The intelligent hardwire kit will power up the dash cam automatically and start recording until the MOTION is cleared.

Please go to <https://www.rexingusa.com/hwk-install/> to watch a video tutorial about the installation or scan the QR code below.



# Warranty & Support

## Warranty

The Rexing C1 Dash Cam comes with a full 12-month warranty. If you register your product on our official site (<https://www.rexingusa.com/support/registration>), you can extend the warranty to 18 months.

## Support

If you have any questions regarding your product, please do not hesitate to contact us at [care@rexingusa.com](mailto:care@rexingusa.com), or call us at (877) 740-8004. Queries are typically answered within 12-24 hours.

## Your opinion matters

Rexing is firmly committed to always improving our products, services, and user experience. If you have any thoughts on how we can do even better, we welcome your constructive feedback and suggestions.

Connect with us today at [care@rexingusa.com](mailto:care@rexingusa.com)

**Thank you for choosing Rexing!**

**FCCID: 2AW5W-C2**

This device complies with part 15 of the FCC Rules. Operation is subject to the following two conditions: (1) This device may not cause harmful interference, and (2) this device must accept any interference received, including interference that may cause undesired operation.

Changes or modifications not expressly approved by the party responsible for compliance could void the user's authority to operate this equipment.

**REXING®**



MADE IN CHINA