

REXING®

CPStream7

User Manual

The information in this manual is subject to change without notice.

Activate Your

18-Month Warranty

& Choose Your

Free Gift!

Activate within 30 days of purchase to claim your free gift and extended limited 12-month warranty to 18 months.

Scan the QR to Activate &
Select Your Free Gift



<https://www.rexingusa.com/productreg/>

Overview

Thank you for choosing **REXING!**

We hope you love your new products as much as we do. If you need assistance, or have any suggestions to improve it, please contact us.

 care@rexingusa.com

 **(877) 740-8004**

Our support team will respond to you as soon as possible.
Always a surprise with Rexing

Check us out here.

- <https://www.facebook.com/rexingusa/>
- <https://www.instagram.com/rexingdashcam/>
- <https://www.rexingusa.com/support/registration/>

 Facebook



 Instagram



 Site



 Product Support



Table of Contents

What's in the box?	4
Product Overview	5
Device Overview - - - - -	6
Installation - - - - -	8
CarPlay - - - - -	10
Android Auto - - - - -	13
AirPlay - - - - -	16
Android Cast - - - - -	18
Bluetooth Music - - - - -	20
Media Player - - - - -	21
Audio output - - - - -	23
Settings - - - - -	26
Troubleshooting - - - - -	29
Product specifications	31
Warranty and Support	34

What's in the box?



1

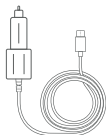

2

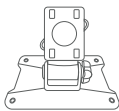

3



4



5

1. Device
2. Power Cable
3. Adhesive Mount
4. Aux Cord
5. User Manual

Product Overview

The CPStream7 is designed for enhanced driving safety with minimal interaction, supporting both Apple CarPlay and Android Auto. Moreover, it boasts the ability to play movies and music directly from an SD card. This feature allows for music playback during drives and movie watching during breaks, ensuring entertainment without compromising safety.

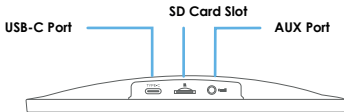
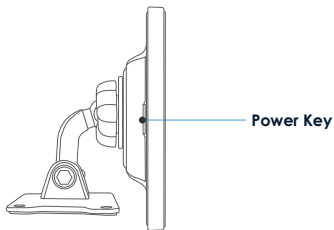

Product Overview

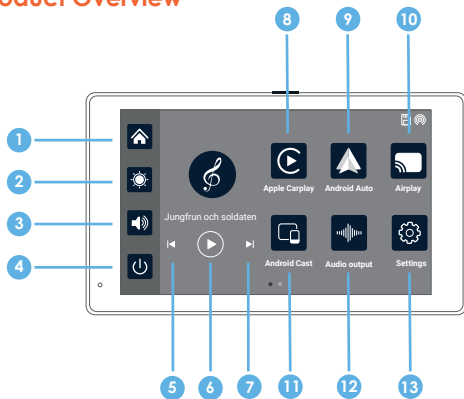

- 1 Home:** Return to home screen
- 2 Brightness:** Adjust screen brightness
- 3 Volume:** Adjust system volume
- 4 Screen off:** Turn screen on/off
- 5 Previous song:** Click to play the previous song
- 6 Play/Pause:** Play or pause the song
- 7 Next song:** Click to play the next song
- 8 CarPlay:** Mirror your apple device
- 9 Android Auto:** Mirror your android device
- 10 Airplay:** stream videos from your iPhone
- 11 Android Cast:** stream videos from your android
- 12 Audio output:** click to select the sound playing mode
- 13 Settings:** view system settings

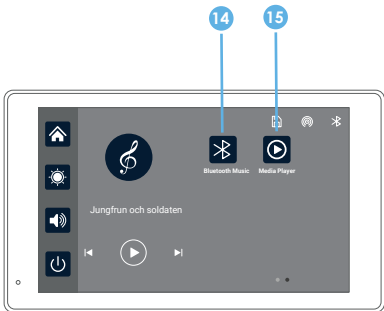

- 14 Click to enter the Bluetooth music playback interface
- 15 Click to enter the movie and music playback interface

Installation

Install the CPStream7

Prepare the Mounting Position:

Clean the dashboard or windshield: Ensure the area where you'll mount the device is clean and free from dirt, oil, or debris. Use a mild cleaner to wipe the surface and dry it thoroughly.

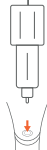

Plug charger into power outlet or cigarette lighter

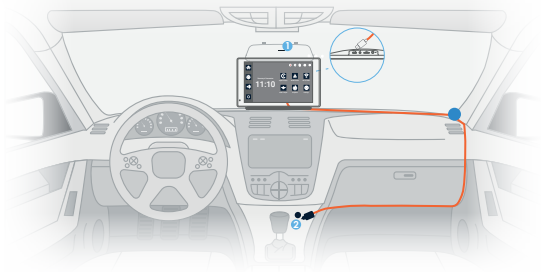

1 Type C interface

To supply power, connect the **(1)** Type-C end of the power cable to the main device, and then insert the **(2)** cigarette lighter plug into the appropriate socket inside your vehicle.

2 Cigarette lighter

Note: Please use the charger provided with the Rexing unit. Using an unauthorized charger may easily damage the device or cause injuries due to insufficient voltage and excessive heat.

CarPlay

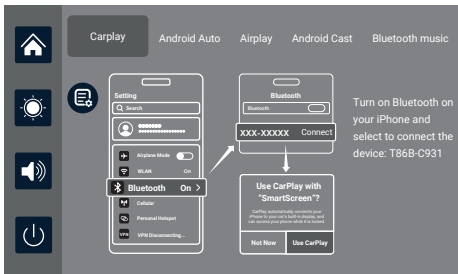

As depicted in the above figure, click the 'CarPlay' button, then select the 'CarPlay' option, and initially, activate the phone's WiFi and Bluetooth, as illustrated in the figure above. Bluetooth will automatically activate and be named T86B-XXX. Once Bluetooth is successfully connected, you can proceed to connect to CarPlay.

Note:

When the machine is powered on, it will attempt to automatically connect to the last connected phone.

Prompting

How to setup:

1. Click Carplay widget on SmartScreen
2. Pair your iPhone to SmartScreen using Bluetooth: T86B-C931
3. When iPhone prompt "Use CarPlay with "SmartScreen"?", selected "Use CarPlay"

Tips:

1. Longer waiting for the first connection
2. Only iPhone phones are supported

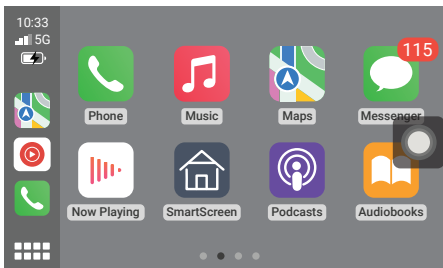

Click Assistive Touch to display the shortcut menu: **Home, Record, Volume, Brightness**

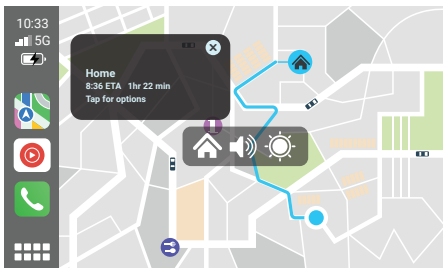

Apple CarPlay is supported only with iPhone models starting from the iPhone 5 and newer. To disconnect, turn-off bluetooth and Wi-Fi on your mobile device.

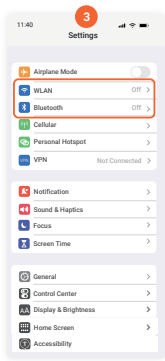
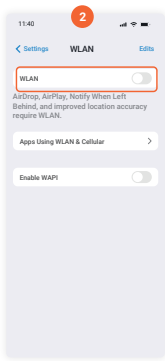
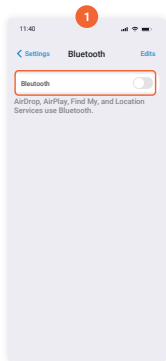

Android Auto

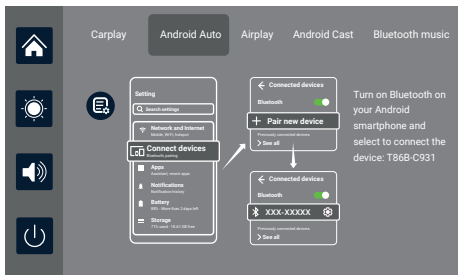

As depicted in the above figure, click the 'Android Auto' button, then select the 'Android Auto' option, and initially, activate the phone's WiFi and Bluetooth, as illustrated in the figure above. Bluetooth will automatically activate and be named T86B-XXX. Once Bluetooth is successfully connected, you can proceed to connect to CarPlay.

Note:

When the machine is powered on, it will attempt to automatically connect to the last connected phone.

Prompting

How to setup:

1. Click Android Auto widget on SmartScreen
2. Pair your phone to SmartScreen using Bluetooth: T86B-C931

Tips:

Please download the latest Android Auto application on your phone

Click the Details button for detailed connection steps and connection FAQs.

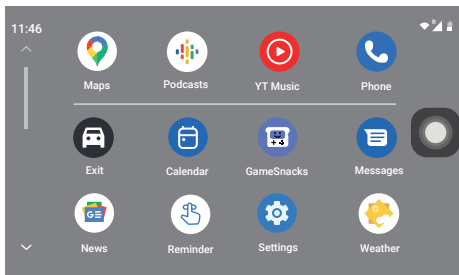

Click Assistive Touch to display the shortcut menu: **Home, Record, Volume, Brightness.**

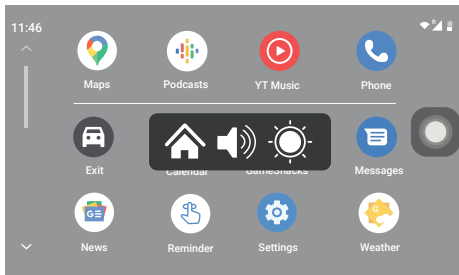

When Assistive Touch is turned off, you can tap the [Exit] button to return to the home page.

Wireless Android Auto option is only supported for Android phones. To disconnect, turn-off bluetooth and Wi-Fi on your mobile device.

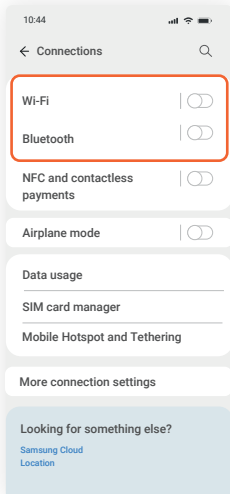

AirPlay

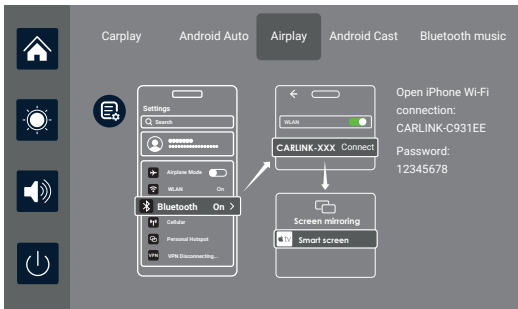

AirPlay can transmit video, audio, and pictures from an iPhone device to car equipment. The transmission medium is WiFi, which is fundamentally different from Bluetooth wireless.

Prompting

Connection steps:

1. Use iPhone to connect to Wi-Fi. Wi-Fi name is: CARLINK-C931EE
2. Wi-Fi password is "12345678"
3. Select SmartScreen in the screen mirroring in the iPhone control center

Tips:

1. Only iPhone phones are supported
2. This mode does not support Bluetooth connectivity

Click the Details button for detailed connection steps and connection FAQs.

1. Requires an iPhone to connect to WiFi

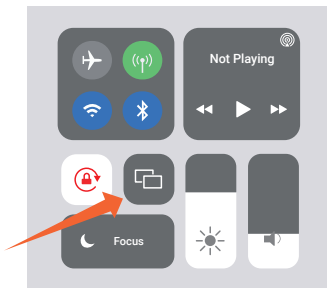

2. Select SmartScreen in Screen Mirroring in the iPhone Control Center

Note:

Only support iPhone

Android Cast

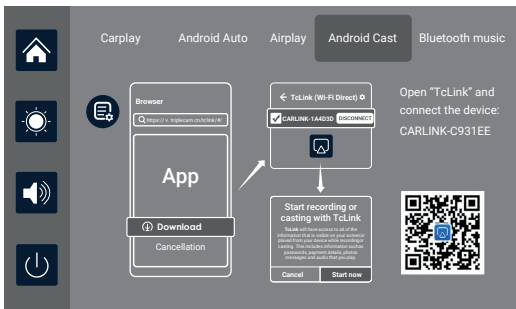

Scan the QR code and download the mobile app to stream a mirror projection of your mobile phone screen onto the adapter's digital display.

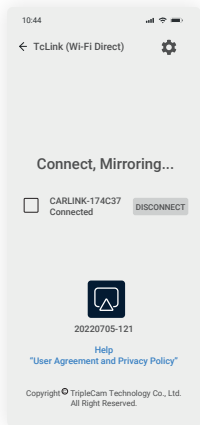

Prompting

How to setup:

1. Selected the "Android Cast" option
2. Scan the code to download, install and run the "TcLink" application
3. Select "Wi-Fi Direct" connection mode, connect this device: CARLINK-C931EE

Tip:

1. Only supports Android phones

Click the Details button for detailed connection steps and connection FAQs.

Note:

Only compatible with Android.

Bluetooth Music

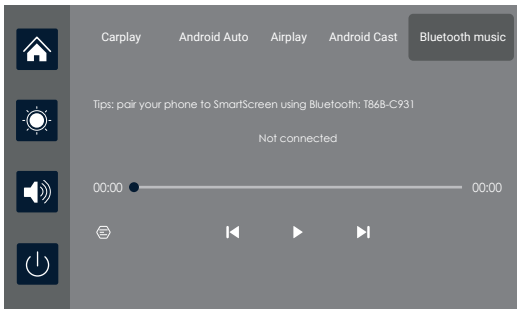

First, turn on your phone's Wi-Fi and Bluetooth. Then, select the [Bluetooth Music] option. Bluetooth will be automatically activated on the Smart Screen, and the Bluetooth name will be displayed in the upper left corner. Connect your smartphone to the adapter's Bluetooth to stream your music.



The buttons correspond to "previous song", "play/pause" and "next song" respectively.





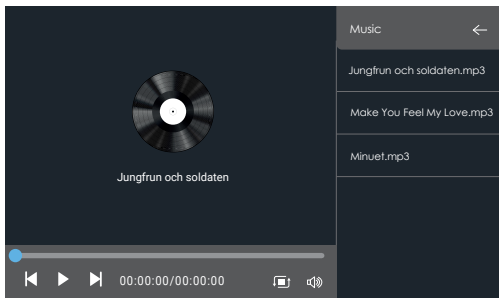
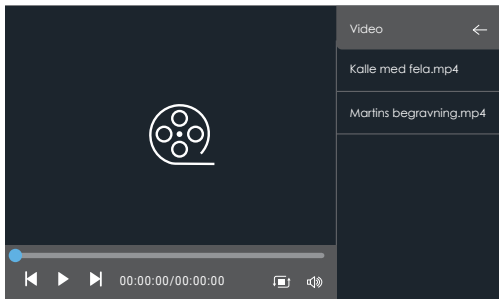

Click on the Lyrics button  to display the lyrics.

Some mobile music player apps do not support displaying lyrics

Media Player

As shown in the figure above, click the [media player] button to enter the movie and music playing interface.



-  Tap to play or pause videos and music.
-  Tap to switch to the next video or music.
-  Tap to switch to the previous video or music.
-  List Loop / Random Play / Single Loop / Sequential Play
-  Tap to adjust the music or movie playback volume
-  Click to return to the previous screen.

Video support format	Coding format
F4V	AVC (H.264)
MOV	AVC (H.264)
MP4	AVC (H.264)
TS	AVC (H.264)

Audio format support: MP3 / WAV

Audio output

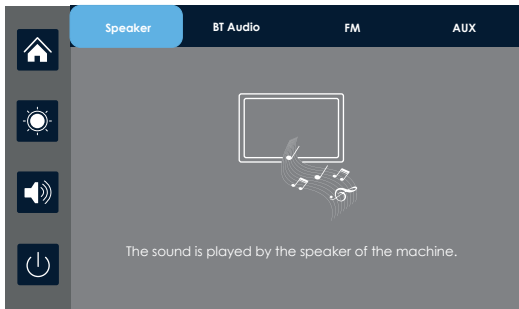

Speaker

The sound will be played from the speaker of the smart screen.

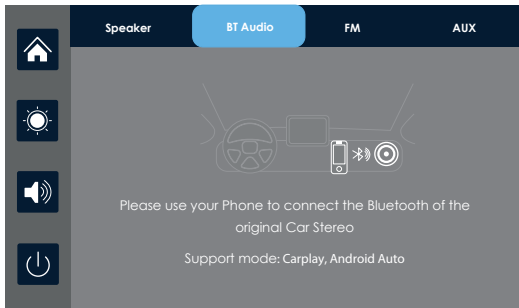

BT Auto

Select BT Audio, and then connect to **CarPlay** or **Android Auto** to cast the screen, you can use the phone's Bluetooth to directly connect to the original car's Bluetooth. After the connection is successful, all sounds from the device will be transmitted to the original car speakers via Bluetooth.

After selecting this mode, the volume icon will change to the Bluetooth transmission icon , and the volume cannot be adjusted on this device, so the volume must be adjusted on the original car.



FM

After selecting FM, the FM transmission mode will be activated by default. For instance, if the device's FM transmit band is tuned to FM 106.0 MHz (any unoccupied channel can be used), the car radio will similarly tune its receive band to the same FM 106.0 MHz. Following a successful connection, all sounds from the device will be transmitted to the original car speakers via FM transmission.

After selecting this mode, the volume icon will change to an FM transmission icon , and the volume cannot be adjusted on this device, so the volume must be adjusted on the original car.

(Not using the original power cord may result in a deterioration of the FM transmission signal or loss of function.)

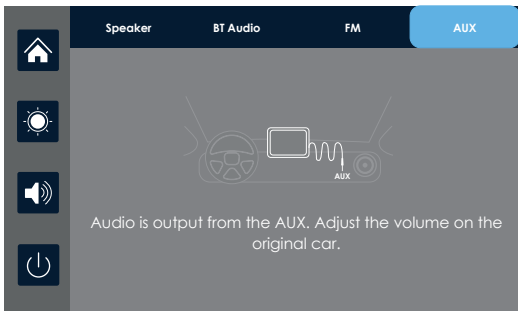

AUX

Upon selecting this mode, the AUX output mode will be activated by default. Utilize the AUX sound source cable to connect the smart screen to the original car. Following a successful connection, all sounds from the device will be transmitted to the original car speakers through the AUX sound source cable for playback.

Upon selecting this mode, the volume icon will change to the AUX output icon , and the volume cannot be adjusted on this device; therefore, adjustments must be made on the original car.

Settings

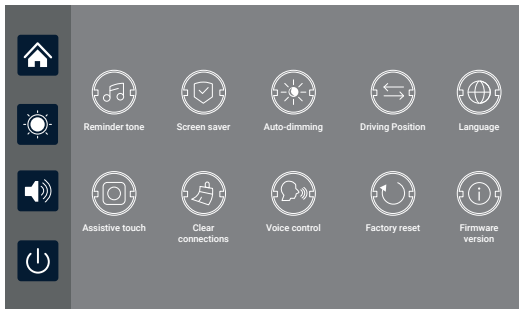

Click on **Reminder tone** to enter the settings: you can choose to turn it off or on. After selecting "off," the power-on sound effect and touch and button sound effects will be disabled. (Different models may have different options, subject to the actual product).



Click **Screen saver** to access settings: the screensaver can be set as Turn off / 10s / 30s / 1min. After setting for 10 seconds or 1 minute, if the system does not operate for the corresponding time, the screen will automatically turn off. After entering the screensaver, press the power button again to turn on the screen.



Click on **Auto-dimmings** to freely set: automatically adjust the brightness time and brightness value.



Click on **Driving Position** to enter the settings:

You can choose between left-hand or right-hand drive, and the shortcut menu bar in CarPlay.

Select left rudder on the left, select right rudder on the right



Click on **Language** to enter the settings: Language can be set:

Simplified Chinese / Traditional Chinese / English / Russian / Spanish / French / German / Japanese / Korean / Arabic / Italian / Portuguese



Assistive touch This is the hover window button in your phone's screen casting mode. You can choose to close or open it. This feature is only supported by Carplay and Android auto modes to hide.



If you change mobile phones, click to clear the connection records of all previous mobile phones.



Click on **Voice Control** to enter the settings:

Voice control commands include: Show rear camera / Turn on display / Turn off display.

After opening the option, on the main interface, say the corresponding command entry, and the system will perform the corresponding operation.



Click **Factory reset** to enter the settings:

Restore factory settings, and the system will restore all settings to their original state.



Click on **Firmware Version** to enter the menu:

This option allows you to see the current basic version for easy confirmation.

Troubleshooting

Number	Problem	Solution
1	Unable to start	<ol style="list-style-type: none">1. Check whether the power cord is damaged or aged.2. Check whether the fuse of the power cord is disconnected or burnt out
2	No touch phenomenon	<ol style="list-style-type: none">1. Touch is invalid during power-on, wait for normal power-on before operation.2. Check whether the touch is damaged, do not touch the screen with sharp objects, it is easy to scratch and damage.
3	High temperature lag phenomenon of the match	The normal operating temperature of T86B PND 7 is -4° F. If the temperature exceeds the limit, disconnect the power. Wait until the temperature of the T86B PND 7 falls below 149° F before turning the power back on to begin operation.

- 4** Carplay cannot connect
- 1.The first connection takes a little longer.
 2. Only iPhone supports Carplay
 3. Check that the Wi-Fi and Bluetooth functions of the mobile phone are normal
 4. Enter Settings - General - Carplay vehicle, delete all records and reconnect.
 5. Restart the iPhone and reconnect it.
 6. Turn on the Siri function on your phone.
-

- 5** Android Auto cannot connect
- 1.Only Android phones are supported.
 2. Update Auto and related applications on mobile phones to the latest version.
 3. Do not enable VPN on the mobile phone.
 4. Check that the Wi-Fi and Bluetooth function of the mobile phone are normal.
 5. Restart the Android phone and connect it again.
-

- 6** The bluetooth music
- Please set the screen casting mode to Bluetooth music. Other modes do not support Bluetooth music.

Reminder: Please ensure that there is no obstruction between the mobile phone and the device, and the WiFi / Bluetooth signal communication is smooth, otherwise the product functions cannot be used smoothly.

Product specifications

System	Language	Simplified Chinese / Traditional Chinese / English / Russian / Spanish / French / German / Japanese / Korean / Italian / Portuguese
	Interface	Graphical menu operation
	Mode of operation	Touch
System Display	Real-time display	7-inch high-definition IPS screen, 1560X720
	The screen saver	Can be set to: Turn off / 10 seconds / 30 seconds / 1 minutes
Wi-Fi Settings	WiFi	Supports CarPlay, Android Auto, Airplay, Android Cast
	Audio emission	Support local speaker playback, BT Audio, FM, AUX

Video	SD card	Play movies and music
Power consumption	Two-way video	Less than 10W (screen display, 2-channel camera recording)
Other	Working temperature	-4 ~ 149°F

Model	CPStream7
Master control	High performance SOC
Wireless function	CarPlay / Android Auto / AirPlay / Android Cast
Screen	7 inch high-definition IPS screen, 1560*720
SD Card	Can play music and movies stored in the SD card
Wireless module	Wi-Fi / Bluetooth / Audio output
Audio output	Speaker, BT Audio, FM, AUX
Working voltage	5V
Power	Less than 10W
Weight	About 300g
Material quality	ABS/PC

Warranty & Support

Warranty

The Rexing CPStream7 comes with a full 12-month warranty. If you register your product on our official site (<https://www.rexingusa.com/support/registration>), you can extend the warranty to 18 months.

Support

If you have any questions regarding your product, please do not hesitate to contact us at care@rexingusa.com, or call us at (877) 740-8004. Queries are typically answered within 12-24 hours.

Your opinion matters

Rexing is firmly committed to always improving our products, services, and user experience. If you have any thoughts on how we can do even better, we welcome your constructive feedback and suggestions.

Connect with us today at care@rexingusa.com

Thank you for choosing Rexing!

FCC ID : 2AW5W-CPDuo7

This device complies with part 15 of the FCC Rules. Operation is subject to the following two conditions: (1) This device may not cause harmful interference, and (2) this device must accept any interference received, including interference that may cause undesired operation.

Changes or modifications not expressly approved by the party responsible for compliance could void the user's authority to operate this equipment.

REXING[®]



MADE IN CHINA