

REXING®

C2 Pro

User Manual

The information in this manual is subject to change without notice.

www.rexing.com

REV03202026

Activate Your

18-Month Warranty

& Unlock Exclusive Perks!

Activate within 30 days of purchase to
extend your limited 12-month warranty to 18 months
and unlock bonus rewards just for registered users.

Scan the QR to register &
discover your exclusive perks.



**SCAN
ME!**



<https://www.rexingusa.com/productreg/>

Overview

Thank you for choosing **REXING!**

We hope you love your new products as much as we do. If you need assistance, or have any suggestions to improve it, please contact us.

 **care@rexingusa.com**

 **(877) 740-8004**

Our support team will respond to you as soon as possible.

Always a surprise with Rexing

Check us out here.

- <https://www.facebook.com/rexingusa/>
- <https://www.instagram.com/rexingdashcam/>
- <https://www.rexingusa.com/support/registration/>

 Facebook



 Instagram



 Site



 Product Support



What's in the Box

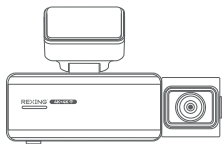

1

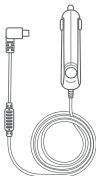

2



4



3

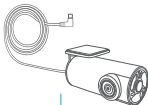

5

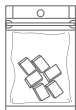

6



7



8



9

1. Rexing C2 Pro Dash Cam
2. Car Charger
3. Warning Sticker
4. Cable Management Tool
5. Rear Camera
6. Cable Clips
7. User Manual
8. Electrostatic Sticker
9. 32 GB MicroSD Card

Camera Overview

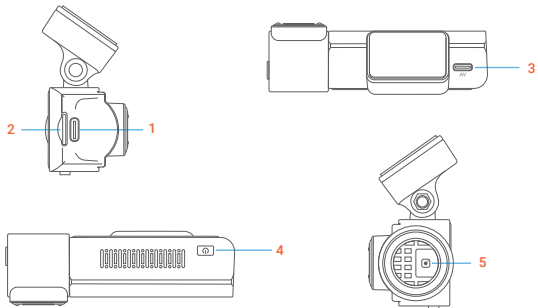

1. USB C Charging Port
2. MicroSD Card Slot
3. Rear Camera Port
4. Hold: Power Button/ Press: Switch View Button
5. Press: Photo Button/ Hold: Reset Button

Screen Icons

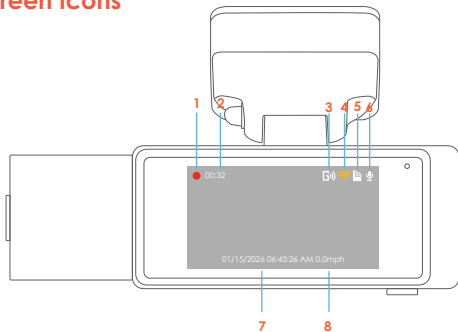

-
1. Recording (On)
 2. Recording Time (Current Clip)
 3. GPS Status
 4. Wi-Fi Status
 5. MicroSD Card Status
 6. Microphone Status
 7. Time and Date (Sync with phone app)
 8. Current Speed (If GPS Connected)
-

Installation

Step 1: Installing the Electrostatic Stickers

1.1 Prepare Your Windshield

Thoroughly cleanse your windshield with either water or alcohol. Follow this by wiping it dry using a clean, dry cloth to ensure a spotless surface.

1.2 Position the Sticker

Next, carefully peel off the protective film from the electrostatic sticker. Attach the sticker to the windshield, ideally behind the rear-view mirror. This position is recommended to avoid obstructing your view while you're on the road.

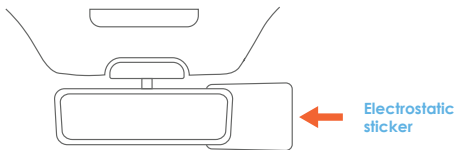

Step 2: Install the Dash Cam

Place the dash cam onto the windshield and properly orient the mount piece to the roof and hood line of the vehicle.

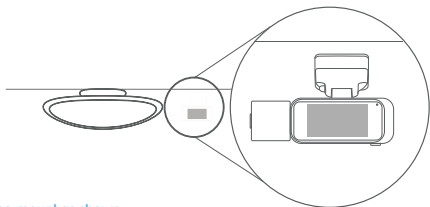

Orient the mount as shown

Step 3: Insert the Memory Card

The Rexing C2 Pro accepts [Class 10/ UHS-1 or higher] Micro SD memory cards up to 256GB. You will need to insert a memory card **before you can begin recording. Before inserting or removing a memory card, first ensure you've powered down the device.**

Gently push the memory card in until you hear a click, and allow the spring release to push the card out.

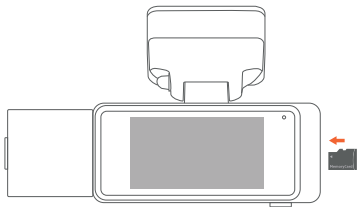

Step 4: Power the Camera and Format the Memory Card

Power the camera by connecting the charger to the car cigarette lighter and the camera

To ensure the C2 Pro records to your memory card properly and without error. **Before you start using a new memory card, you must format the card within the camera using the format function.** Always backup important data stored on the memory card before formatting.

To format the memory card, make sure you have inserted your memory card, **then turn on the device by connecting to a power source.** If the memory card needs formatting, a prompt will appear on the screen. Press the Power button to format the memory card. Once formatting is complete, the device will automatically start recording. Formatting may take a few minutes.

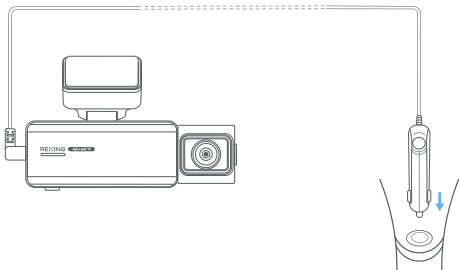

You may now disconnect from power. The camera will shut down after 3 seconds. The camera should begin recording automatically the next time it is powered on.

Before formatting your memory card, always remember to make backup copies of all important data stored on the device. The manufacturer's warranty does not cover loss of data resulting from user actions.

It's recommended that you format your memory card after transferring files to your computer or at least once a month.

Step 5: Mount the Rear Camera

Mount the rear cameras as shown below. Use the provided camera cable to connect the rear cameras to the front camera.

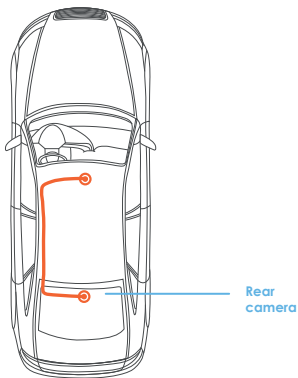

Step 6: Installing the Camera onto the Windshield

Carefully route the power cable around the windscreen and tuck in under the trim.

Plug the Car Charger Cable into a 12V DC power outlet or the car cigarette lighter.

Connect car charger to the camera. The camera will auto-start recording once powered on.

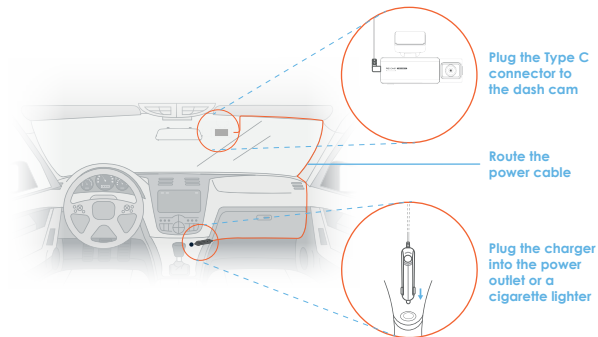

Basic Operation

Device Power

The device is automatically powered on when plugged into a 12V accessory socket or cigarette lighter and receives a charge (i.e.: the vehicle is started).

To turn the device on manually, press and hold the **POWER** button until the welcome screen appears.

The camera will automatically start recording when powered on.

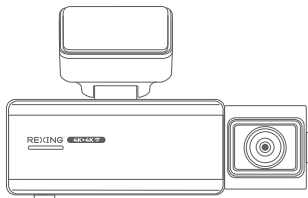

Press and hold the **POWER** button to turn the device on manually

Video Recording

The camera will automatically begin recording when it receives power. A blinking red dot and indicator icon will appear on the screen while recording is in progress.

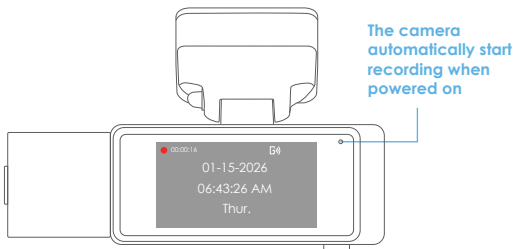

Memory Card Size	FHD P30
16GB	3.5 hours
32GB	7 hours
64GB	14 hours
128GB	28 hours
256GB	56 hours

Loop Recording

The dash cam records video continuously in segments. When the memory card is full, new recordings will automatically overwrite the oldest unlocked files. Locked files will not be overwritten and will remain on the card until they are manually deleted or the card is formatted. We recommend keeping Loop Recording enabled.

G-Sensor Sensitivity

The G-Sensor is set to Low by default. Increasing the sensitivity may result in more videos being locked.

Parking Monitor (Parking Surveillance Mode)

Parking monitor provides surveillance on your parked vehicle. When the engine is off, the hardwire kit is used to provide continuous power and protect your car battery from being discharged.

We kindly suggest taking a moment to watch our tutorial video. It's designed to help you have a smooth and successful installation experience. We believe you'll find it very helpful!

Please go to <https://www.rexingusa.com/ihwinstall> or scan QR code



Option 1: Vibration Detection

To enable the Parking Monitor, you'll need to connect it with a Rexing Type-C Smart Hardwire Kit (Sold Separately).

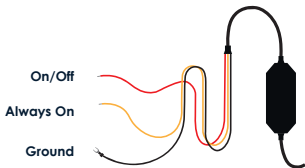

This feature will allow the dash cam to switch to parking mode automatically if the vehicle's engine turns off and switch back to the normal recording after the vehicle's engine turns on.

Gravity Sensing Record:

The Gravity Sensing detects significant or sudden movement (such as an impact or collision), it will trigger an event recording. We suggest setting the "Gravity Sensing" to High sensitivity for Parking Mode Recording.

Please **DO NOT ENABLE** the Parking Monitor function in the settings of the dash cam **WITHOUT** connecting a smart hardwire kit. They may cause a malfunction.

Option 2: Motion Detection

To use this feature, you need to connect it with a Rexing 360° Intelligent Hardwire Kit (sold separately). Make sure that the Parking Mode is turned off on your dash cam.

Make sure that the Parking Mode is **turned off** on your dash cam, otherwise it may cause a malfunction.

Once the sensor has detected **MOTIONS**. The intelligent hardwire kit will power up the dash cam automatically and start recording until the **MOTION** is cleared.

Wi-Fi Connect

Step 1

With your dash cam powered on, tap the POWER button twice to activate the Wi-Fi function.

The Wi-Fi name (SSID) and password for the dash cam will be displayed on the screen.

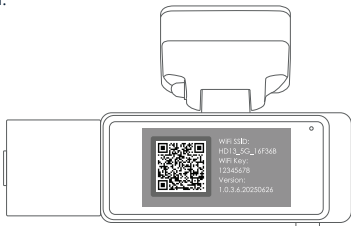

Step 2

On your mobile device, navigate to your Wi-Fi settings. Connect to your dash cam's Wi-Fi by tapping its name when it appears. Enter your dash cam's Wi-Fi password if you are prompted to do so.

Note: On some mobile devices, you may have to try to connect more than once. To ensure you've successfully connected, your mobile device's screen should resemble the examples shown.

Samsung / Android Example

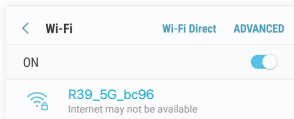

iPhone / iOS Example



Step 3

Once you're connected to the dash cam, open the REXING Connect app on your mobile device.

Please select "Keep Trying Wi-Fi" if you see the notification on the right.



Step 4

In the app, hit the "Connect" button to connect to your dash cam, allowing you to access live view and view/download your recordings.

Note: Turn OFF your phone Wi-Fi to disconnect.

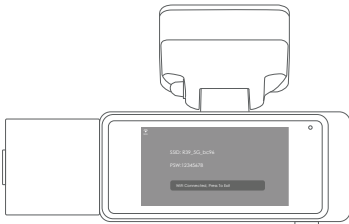

Rexing Connect App

Easily download the app by scanning the QR code below or search via the App Store or Google Play.



Wi-Fi Connect Troubleshooting

If you bring up the Rexing connect app and cannot connect your phone to the dash cam please go to <https://www.rexingusa.com/wifi-connect/> OR scan the QR code below.



Menu Settings

APP Main Screen

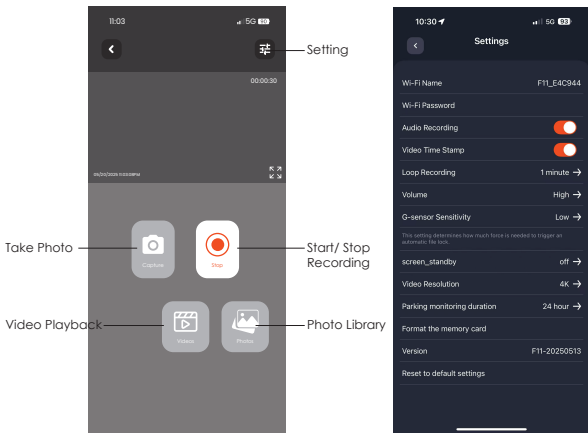

Time and Date

Updates automatically to match your phone when the app is connected.

Video Playback

The video playback can be accessed from the app home screen.

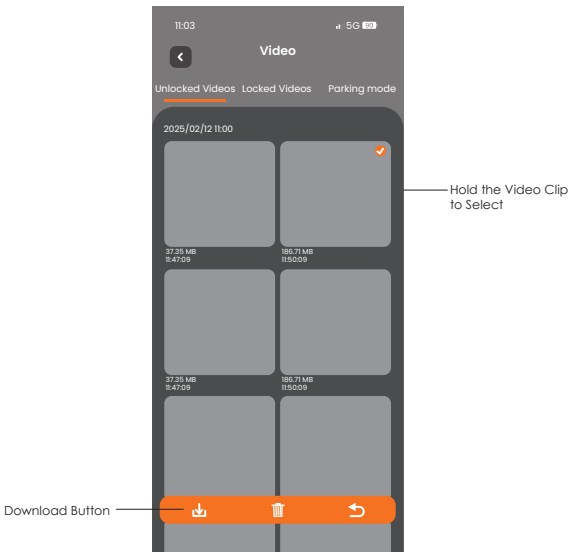

GPS Logger (Sold Separately)

To activate the GPS logger feature, connect the GPS logger (sold separately) to the dash cam. The dash cam will automatically search for a GPS signal once connected to a power source.

You can then access this information while playing back your recordings using the GPS Video player. For Windows and Mac, available at <http://www.rexingusa.com/support/rexing-apps/>.

After a GPS signal is found, the screen icon will turn from white to green. Please visit gpsa.rexingusa.com to watch a video tutorial.

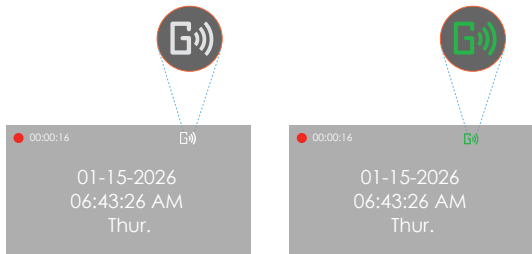

GPS Date-Time Troubleshooting

If your dash cam GPS date and time are incorrect please go to <https://www.rexingusa.com/gps-date-time/> OR scan the QR code below.



Warranty & Support

Warranty

The Rexing C2 Pro Dash Cam comes with a limited 12-month warranty. If you register your product on our official site (<https://www.rexingusa.com/support/registration>), you can extend the limited warranty to 18 months.

Support

If you have any questions regarding your product, please do not hesitate to contact us at care@rexingusa.com, or call us at (877) 740-8004. Queries are typically answered within 12-24 hours.

Your opinion matters

Rexing is firmly committed to always improving our products, services, and user experience. If you have any thoughts on how we can do even better, we welcome your constructive feedback and suggestions.

Connect with us today at care@rexingusa.com

Thank you for choosing Rexing!

FCCID: 2AW5W-C2Pro

This device complies with part 15 of the FCC Rules. Operation is subject to the following two conditions: (1) This device may not cause harmful interference, and (2) this device must accept any interference received, including interference that may cause undesired operation.

Changes or modifications not expressly approved by the party responsible for compliance could void the user's authority to operate this equipment.

REXING[®]



MADE IN CHINA